



Solar Drive System SOLAR PRO II

The unique modular solar drive system



- For roller shutters, screens, awnings, venetian blinds, windows etc.
- Solar panel, battery and controller combined in a compact and handy unit.
- Tubular motors from 10 Nm up to 35Nm, lateral motor, square motor Q6 and more
- Modular concept for variable composition of module sections and multiple applications.
- True „plug & play“! Mounted and set up in a flash - fitters are delighted!
- No wiring, no disruption, no electrician required
- Easy recharging and re-placing of batteries, if required.
- Perfect for retrofitting.
- Environmentally friendly, energy saving, sustainable

Technical specification

Solar pro II 4A/2.5W (standard version)

Tension:	12 Volt
Capacity Panel:	2,5 W
Battery:	4 A
Length:	624 mm

Solar pro II 4A/4W

Tension:	12 Volt
Capacity Panel:	4 W
Battery:	4 A
Length:	787 mm

Solar pro II 8 A - 4 W

Tension:	12 Volt
Capacity Panel:	5 W
Battery:	8 A
Length:	861 mm

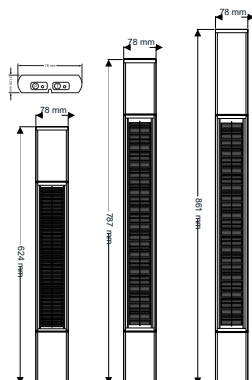



New!
 „HD“-version for
 drywall installation!



ACCUFIX - Inwall switch with integrated battery

Makes blinds and shutters safer in case of emergency!



- Enables operation of roller-shutters, blinds, screens, venetian blinds, black-out blinds etc. also in case of a power blackout
- Up to 20 cycles of operation in battery mode
- Fits into standard „inwall“ installation boxes (71mm)
- Acoustic detection of ANY smoke detector alarm; no wiring required
- Alarm function will be operated automatically. Faulty operation by user is excluded
- connects to Mediola-Smarthome-System
- Easy operation by buttons, remote control and/or integrated timer
- Permanent charging and surveillance of integrated batteries; Long term maintenance cyclus (4 years)
- Easy, fast, affordable

Technichal specification:

Input: 110/230V
 Output: 12V (24V)
 Dimension controller: 50 x 50 x 15 mm
 Dimension inwall box: 57 x 57 x 61 mm
 RF frequency: 868,3 Mhz
 Frequence of alarm: 2,5 KHZ - 4,0 KHZ
 Batteries: LiPo, 4 x 3,7V=14,8V
 Capacity batteries: 350 mAh
 IP protection class: Ip20
 Operation temp.: +4° - +40°C

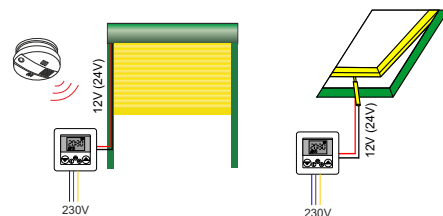
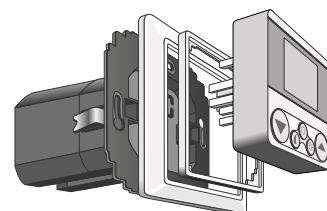
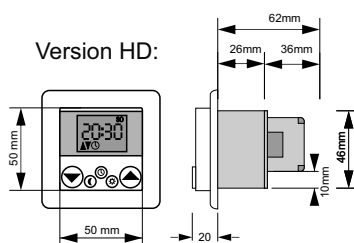
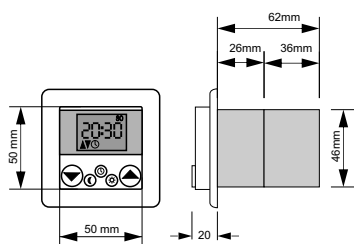

www.ozroll.eu

New!
Now connected to
EVERHOME Smart-home

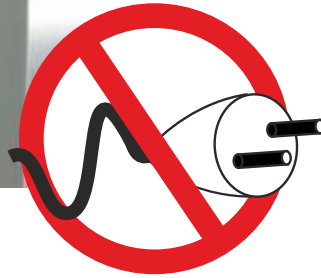

OZRoll Drive System

The unique Battery Drive System



- Portable controller with integrated rechargeable batteries
- 12V DC tubular motors 10 to 35Nm, lateral motor, venetian blind motor etc.
- No connection to mains power, no disruption, no electrician required
- Perfect in applications without mains power: bathrooms, summer houses etc.
- Easy recharging in the wallplate or at any power outlet
- A single E-Port controller can operate multiple shutters
- Remote control optional
- Easy replacement of battery controller, if required
- Solar panel SOLAR HOME upgrades ODS into the ideal solar drive system
- E-3-Way switch for more comfort

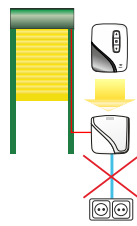

The E-Port controller comes with built-in rechargeable Li-Ion-batteries. It slides into the wallplate and provisions the system with electric power.

No connection to mains power required!

Controller, : E-Port kann in der Wandhalterung oder an einer beliebigen Stelle aufgeladen werden und bedient den Rollläden wochenlang



Mit dem Seitenmotor L10 können auch schmalste Rollläden elektrisch bedient werden; aber auch für große Rollläden, Markisen und andere Sonnenschutzanlagen bietet OZRoll immer die richtige Lösung!

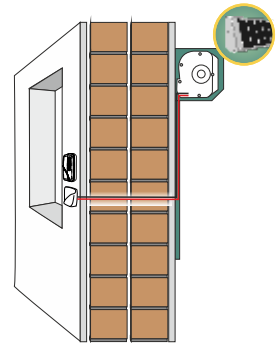

Der Motor wird mit einer zweipoligen 12-Volt-Leitung mit der Wandhalterung im Rauminneren verbunden. E-Port versorgt die Anlage mit Strom

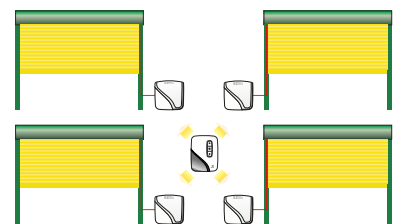

x : 1 - Lösung: Ein E-Port kann mehrere Rollläden bedienen. Das spart Kosten und macht das OZRoll-Drive-System zu einer einfachen und preiswerten Anschaffung

New!
Highspeed motors
up to 60 rpm!



OZRoll DC motors

For blinds and shutters, awnings, furniture, automotive industry and more



We Simply Do It Better

- Tubular motors from 10 to 35 Nm with mechanical endstop
- High duty cycle for frequent and long term operation
- solid, well-proven quality
- Adaptors for all common axle types available
- wide range of accessories on stock
- Lateral motor for narrow shutters and other applications
- Venetian blind motor Q6 with electronic endstop setting
- Operation with OZRoll Solar Pro, E-Port or ACCUFIX
- Alternative operation with user-specific control systems
- High speed tubular motors up to 60 rpm

Tubular Motor T10, 12V 10Nm

Length: 556 mm
 Tube diameter: 35 mm
 Current: 12 V DC
 Torque: ca. 10 Nm
 IP class: Ip44
 Operating temp.: -20°C/+60°C
 Consumption: max. 2,8 A
 Speed: 16 rpm

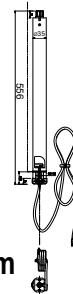

Tubular Motor T20, 12V 20Nm

Length: 587 mm
 Tube diameter: 45 mm
 Current: 12 V DC
 Torque: approx. 20 Nm
 IP class: Ip44
 Operating temp.: -20°C/+60°C
 Consumption: max. 2,8 A
 Speed: 16 rpm

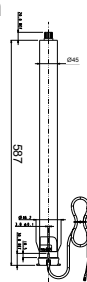

Tubular Motor T35, 12V 35Nm

Length: 587 mm
 Tube diameter: 45 mm
 Current: 12 V DC
 Torque: approx. 35 Nm
 IP class: Ip44
 Operating temp.: -20°C/+60°C
 Consumption: max. 2,8 A
 Speed: 12 rpm

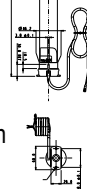

Venetian-Blind-Motor Q6

Torque: 2 x 3 Nm
 Current: 12 V
 Operating temperature: -5°C/+50°C
 Speed: approx 20 rpm
 Consumption: approx. 3A
 IP-class: Ip54
 Total length: 260 mm

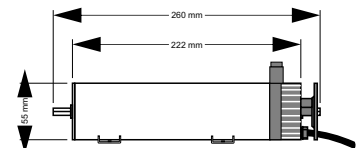

Lateral Motor L10

Torque: 10 Nm
 Tension: 12 V
 Operating temp.: -20°C/+60°C
 Geschwindigkeit: approx. 16rpm
 Consumption: approx. 3,6A
 IP protection class: Ip44

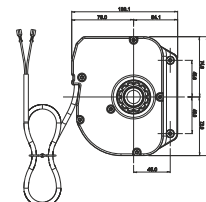

www.ozroll.eu